



7919.06NMV.00

GN 600 NMV GN 2/1 ARMOIRE REFRIGEREE POSITIVE UNE PORTE

Page 1
@OZT693: V23.0

@OZT689

@OZT690	@OZT695	@OZT691	@OZT694	@OZT695
6201.00030.27	CHARNIERE FORCEE DE RESSORT POUR PORTES D'ARMOIRE			
2919.06NMV.M0001.00	Charniere de porte 06NMV			
6213.00001.41	M5*10 SS HEX BOLT WITH FLANGE			
6201.00030.64	SUPPORT DE CHARNIERE			
6800.00003.28	PLASTIC CABINET BASE-PREMIER K/M- F 70			
6213.00002.19	M5x16 S/S COUNTERSINKING HEAD CROSS RECESS SCREW			
6800.00007.38	CONTROL UNIT COVER BOTTOM BODY			
6800.00007.39	CONTROL UNIT COVER REAR LID			
6800.00003.22	PLASTIC VENT MONOBLOCK-SINGLE FAN			
6201.00030.042	CHARNIERE DE CABINET			
6239.00002.00	SELF ADHESIVE TIE MOUNT 28X28			
6201.00030.65	GOUPILLE DE CHARNIERE			
6020.00039.02	INSULATION PASTE			
6243.00011.00	HEAT SHRINK TUBE Q10 BLACK			
6011.00009.052	ALUMINIUM TAPE 50 MM WIDTH 50 MICRON			
6020.00039.02	INSULATION PASTE			
6214.00002.00	M4 GALVANIZED NUT			
6606.00001.12	Grommet rubber Ø8x16			
6800.00003.34	LOCK LIP STRIKE			
6268.00025.04	SUBAP KAPAK 6MM PRINC CASTEL			
6218.00002.00	FASTENER SPIN TYPE M5 NO CAP WITH CD COAT.			
6214.00002.01	ECROU GALVANISE M6			
6213.00007.21	SHEET METAL SCREW 3,9x13 YSB GALV. DRILL BIT			
6212.00002.18	M8*20 HEX SS BOLT			
6003.00010.090	DIK DOLAP EVAPORATOR KUTU KEMERI		BB0	
6268.00009.00	ROUE D'ALUMINIUM Q20 CM-28 °		BL1	
6201.00030.65	GOUPILLE DE CHARNIERE		CAHP	
6268.00001.15	CAPILLARY 0,90x2,20 M		CAP2	
6201.00030.32	CANOPY HINGE 245-061-061		CH1	
6201.00030.64	SUPPORT DE CHARNIERE		CH2	
6268.00006.00	COMPRESSOR EMBRACO EM 65 HHR		COM2	
6268.00010.011	CONDENSER 4R-10T-200-1,6 (MA 20 162)		CON2	
6213.00006.04	SAC VIDASI 3,9*13 YHB INOX MATKAP UCLU		CP43	
2919.06NMV.BC086.00	KANOP GN 600 MONO 304 EVJ		CP43	
9099.00049.12	Heating cable PVC - 230V - 21W Lenght incl. coldzone 4510mm Termination: Faston 6,3x0,8		DOH1	
6268.00003.03	SECHOIR 20 GR		DR1	
6011.00004.32	COUVERTURE EVAPORATEUR EPS POUR ARMOIRE REFRIGEREE		EB2	
6234.00009.49	THERMOSTAT DIGITAL EVCO EV3B22N7		EC2	
6268.00001.51	CUPPER PIPE 3/16 FOR RE-EVAPORATION		EP1	
6268.00011.60	EVAPORATEUR GN 600 NMV		EV9	
6268.00008.24	MOTEUR FAN EBM 5W M4Q045-BD01-01-A57		FM1	
6268.00012.32	JOINT MAGNETIQUE GN 600 S 574*1530 MM		GA4	
6201.00030.042	CHARNIERE DE CABINET		HC3	
6201.00030.27	CHARNIERE FORCEE DE RESSORT POUR PORTES D'ARMOIRE		HMC2	
2919.06NMV.KA01.00	PORTE SOLIDE (UNE PORTE GN 600) 304		KA01	
6800.00001.57	FRONT PANEL LABEL-OZTIRYAKILER EKO		LB1	
6250.00001.184	LUMIERE INTERIEURE 3,2-4,7W 230 V LED		LED6	
6260.00002.10	PIED REGLABLE AVEC 130-180H mm 90x100 PLAQUE DE FIXATION		LG10	
9099.G5VBO.1M5511	VERROU POUR L'ARMOIRE REFRIGEREE		LK2	
6800.00003.34	LOCK LIP STRIKE		LLS1	
6228.00002.07	ORING Q13		OR2	
6257.00009.21	POWER CORD WITH BRITISH PLUG		PC3	
2KLP.460.00140030.9.01	DIGITAL SENSOR COVER PART		SCP1	
6260.00094.10	CABLE GROUP FOR LIGHT SOCKET		SH1	
6268.00019.36	GRILLE PLASTIFIE PVC GN 2/1		SH2	
6232.00028.00	BOUTON DR-104 2,5A 250V AC NOVA		SW20	
6268.00015.01	FIL DE PROTECTION POUR VENTILATEUR Q20 CM		WG1	

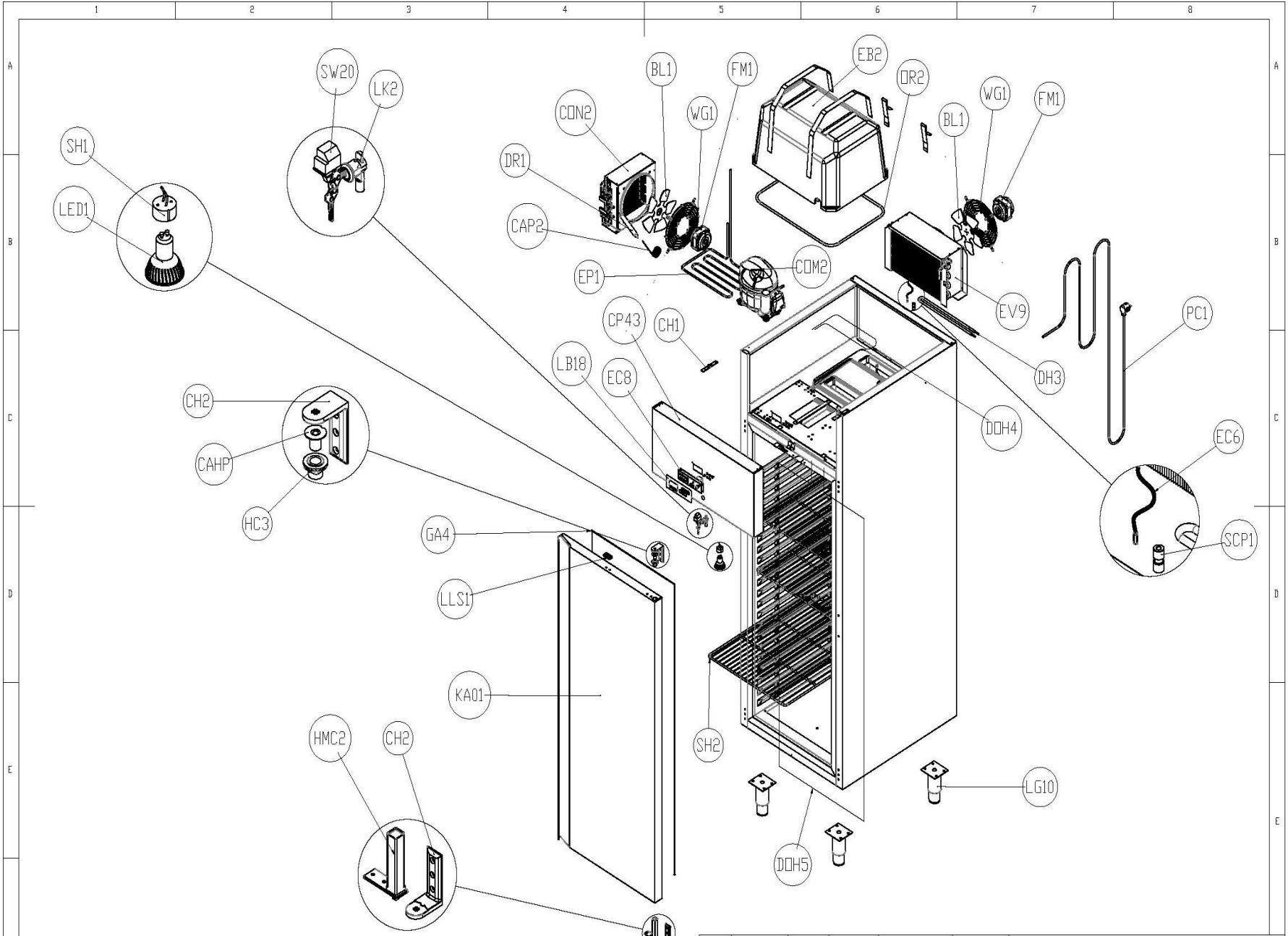

ARGE
KONTROLLÜ KOPYA

RİD	İSM	MZA	TARİHİ	VERSİYON	TOLERANS	
ÇİZEN	B.TASKIRAN		6.6.2018	V19.12	İDN 7168	PARÇA ADI 7919.06NMV.00 ST TYPE EXP. VIEW
KONTROL	M.HACI		6.6.2018		ORTA	
İNAY	M.HACI		6.6.2018		REVİZYON 0	
					ALÇEK 105	
RESİM ÖZERAKDEN ALIÇI ALMAYINIZI		EKLİLERİN ÇIKARILMADIR		AHIRLIK (kg)	-	T.PRESİM NO

öztiryakiler