

01/2020

Mod: RVG/2-SBC

Production code: MN2EG

CHAPTER 5

ASSEMBLY OF SPARE PARTS

WARNING: These operations can only be done by an authorised technician

CHANGING THE MOTOR REDUCER

- remove the Disconnect the oven from the mains. Remove the cover of the transmission on the left side of the oven by loosening the screws fastening it.
- Loosen the screws (4) Fig. 10 to remove the chain that joins the pinion (3) and the axle of the first spit.
- Once the chain has been removed, totally remove the screws (4) to take out the motor support (5) along with the motor reducer.
- Loosen the screw fastening the pinion (3) to the axle of the motor reducer to remove it from the axle. Totally screws (2) to dismount the motor reducer from the support.
- Change the motor reducer and proceed in reverse order to what is explained above to assemble it.

WARNING When correctly tautened the motor chain should have a flexion in the centre of about 1 cm. An excessively taut chain produces unnecessary work stress on the motor reducer.

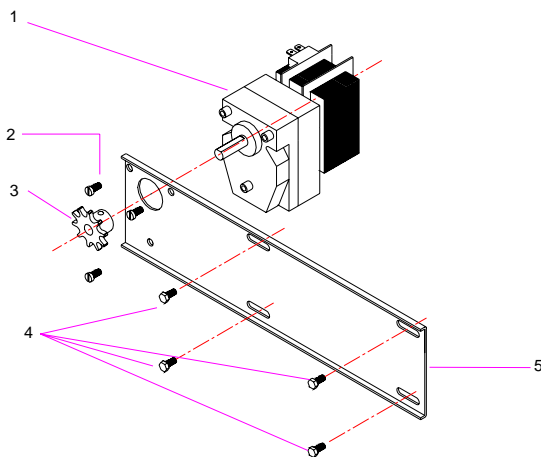

CHANGING A VALVE

- Disconnect the oven from the mains and close the gas supply. **Make sure the gas supply is closed before you continue with this operation.**
- Remove all the valve controls (on the right of the oven) by pulling them outwards.
- Remove totally the screws fastening the controls panel and remove it
- Loosen the tube (12) (See Fig. 7) by loosening the nuts (11) of the valve you wish to change. Then dismount the thermocouple of the valve by loosening the nut (15).
- Totally loosen the screws (10) which, together with the bracket (9), fasten the valve to the battery.
- Proceed in reverse order to what is explained above to assemble the new valve. Do not forget to replace the washer of the joint (1) with a new one.
- Make sure there are no gas leaks. Then adjust the minimum of the burner and finally replace the controls panel.

CHANGING A THERMOCUPLE

- a) Disconnect the oven from the mains and close the gas supply. **Make sure that the gas supply is closed before you continue with this operation.**
- f) Remove all the valve controls (on the right of the oven) by pulling them outwards.
- g) Loosen totally the screws fastening the controls panel and remove it
- h) Loosen the nuts (15) and (9) (See Fig. 7) of the thermocouple you wish to change and remove it.
- i) Assemble the new thermocouple by proceeding in reverse order to what is explained above. Then replace the controls panel and controls.

CHANGING A BURNER

- a) Disconnect the oven from the mains and close the gas supply. **Make sure that the gas supply is closed before you continue with this operation.**
- b) Remove all the valve controls (on the right of the oven) by pulling them outwards. Then remove the top and bottom inter-burner sheets of the burner you wish to change.
- c) Remove totally the screws fastening the controls panel and remove it
- d) Remove totally the screws fastening the rear panel and pull it towards the left to remove it
- e) Remove the tube (12) and thermocouple (13) (See Fig. 11) corresponding to the valve of the burner you wish to change by loosening the nuts (11) and (14).
- f) Pull the elbow piece (8) outwards to remove the Venturi burner. Totally loosen the screws fastening the burner (16) to its support (17).
- g) Replace the burner and assemble the new one in its support.
- h) Proceed in reverse order to what is explained above to assemble it. **MAKE SURE** there are no gas leaks. Replace the panels and do not forget to adjust the minimum of the burner.

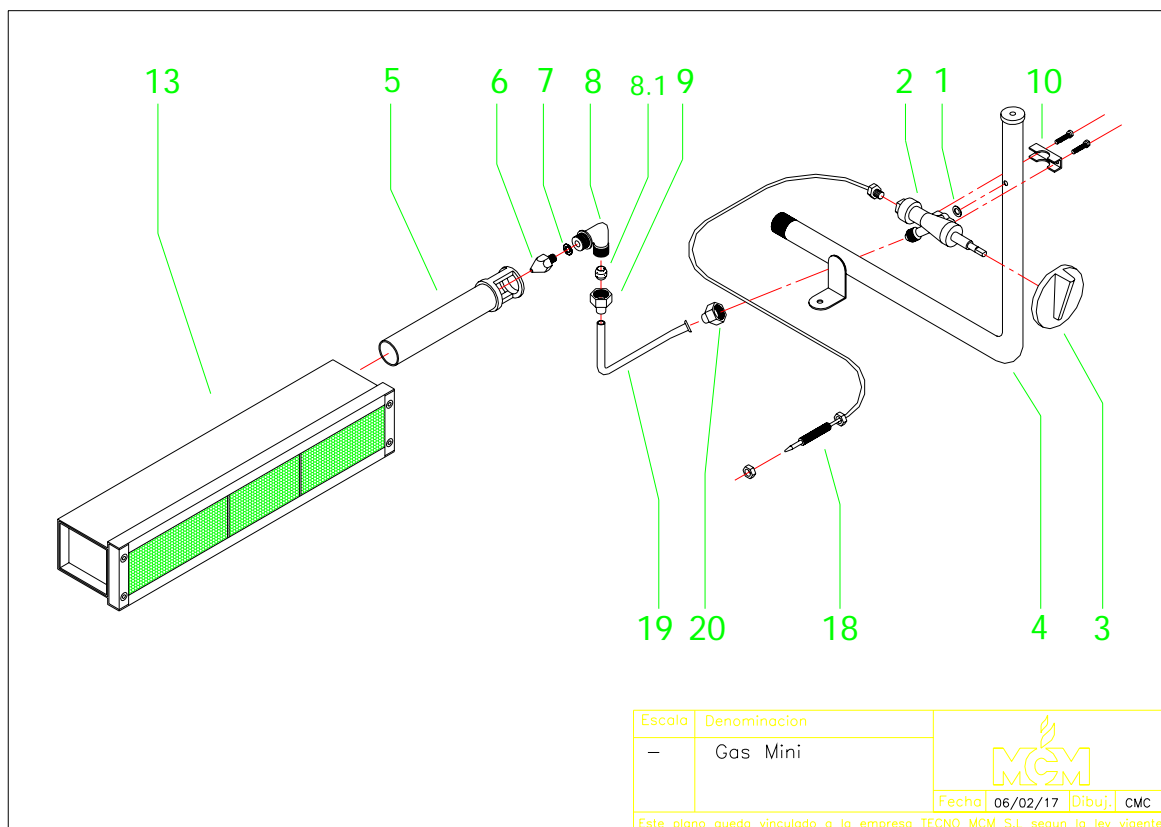

Fig 11

APPENDIX A

List of spare parts that may require changing. Electric diagram.

Denomination	Code
Burner	193001
Safety valve	030112
Thermocouple	030115
Butane/Propane injector	23009
Natural Gas injector	4400012
Motor reducer 220V	020112
Simple switch	060004
Simple Skewer (without screw)	050107
Double Skewer	050110
Skewer screw	050116
Oven glass, model. RVG/2-SBC	194201
Oven glass, model. RVG/3-SBC	194301